

**DESIGNER GUIDE TECHNICAL
PROFILE DETAIL**

CLEARLINE FR SINGLE & DOUBLE GLAZED

Double Glazed

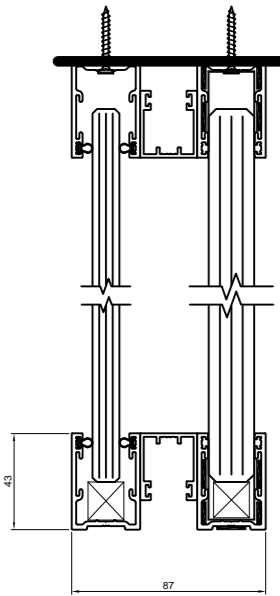

Single Glazed



Doorframe Head Detail

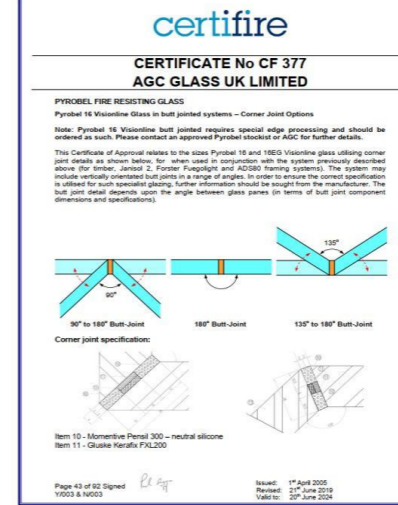
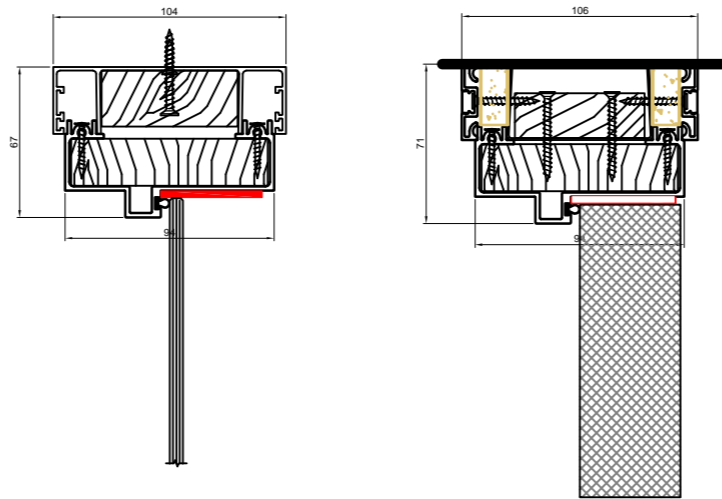

Double Glazed Screen Example

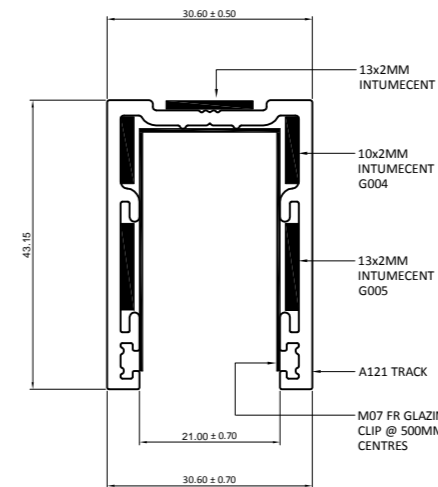
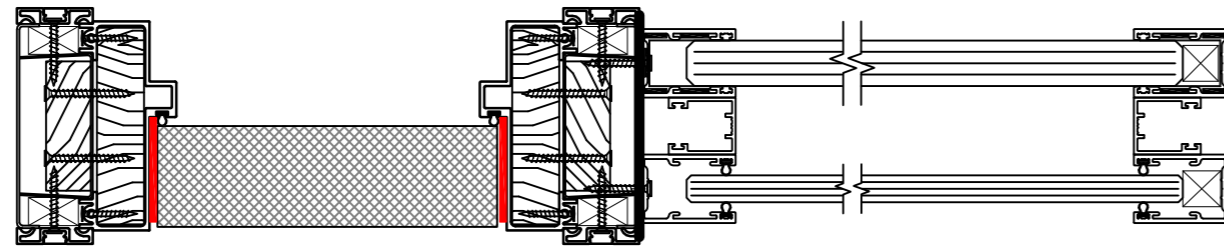
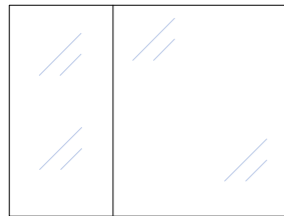

Single Glazed Screen Example

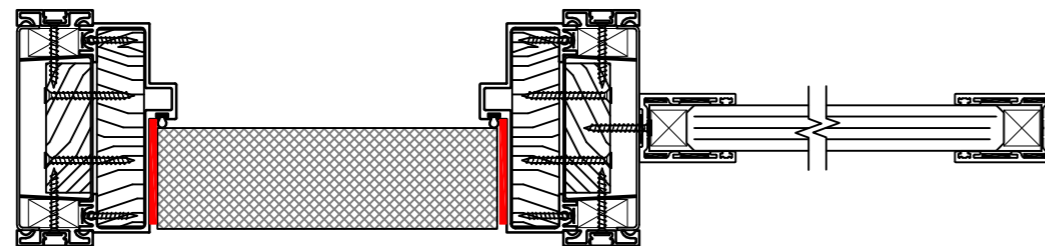
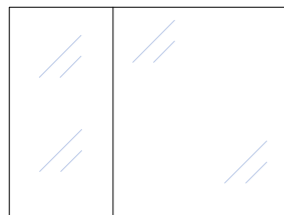

Fire Rated Door Glass Details

- A - P256 Standard Neslo seal
- B - K232-FR Neslo Doorframe
- C - R126 Lift Off Hinge
- D - Rundo Patch Latch
- E - R109 SSS Lever Handle
- F - R132 Neslo Strike Plate
- G - G003 Low Pressure Intumescents
- H - G002 Encased Intumescents
- I - 10/12mm Pyran S Door

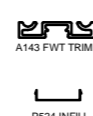
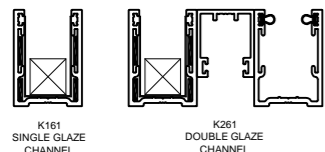
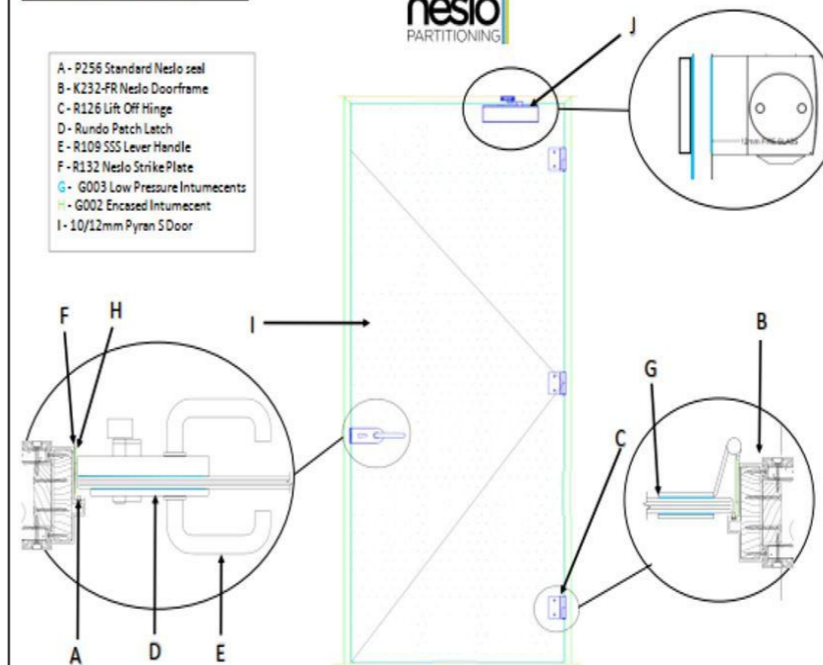

P524 INFILL



SYSTEM TYPE	
CLEARLINE FR	
Partition Specifications	
Fire Rated	30/0 using 30/30 glass
Structural	Up To 1.5 kN Line Load Available
Deflection	N/A
Acoustic	Up To Rw 41db
SYSTEM MATERIALS & FINISHES	
Materials	Aluminium / Steel
Finish	RAL TBC
Glass SG Glass DG	17mm fire glass 10mm CFT-17mm fire glass
Note: ** Some acoustic tests have been undertaken with a double glazed single panel with trims to all four edges. Please contact Neslo Technical for a full list of results.	
DOOR MATERIALS & FINISHES	
Timber	Tested solid core fire rated door (Halspan)
Glass	Up to 12mm PyranS
DOOR SPECIFICATION	
Timber	Solid core veneered to suit manufacturers Rwdb rating
Glass	Up to Rw 34db
TYPICAL IRONMONGERY TYPES/FINISHES	
To suit fire requirements as details	
PERIMETER FIXINGS	
The perimeter fixings used for the test were 32mm long x 4mm brass zinc plated screws into plastic plugs @ 600mm centres.	
It should be noted that each project has different site conditions and support systems, and therefore the partition base and head fixings are bespoke and job specific and must be designed for every project.	
Drawing No:	SG DG-CL-FR
Version:	01
 Neslo Partitioning 53 Victoria Road Burgess Hill RH15 9LH Tel: 03333 583003 Neslopartitioning.co.uk	